

B AC Motors

2 Pole Motor 200W(□ 90mm)

200W 2 Pole Motor 200W(□ 90mm)

Motor Specification

Model		Output	Voltage	Frequency	Poles	Duty	Starting Torque		Rated Load			Capacitor	
Lead Wire Type	Terminal Box Type						kgfcm	N.m	Speed	Current	Torque		μF / VAC
9IDD*-200F-A(T): D-Cut Type Shaft 9IDK*-200F-A(T): Key Type Shaft		W	V	Hz				r/min	A	kgfcm	N.m		
9IDD3(G)-200F-A	9IDD3(G)-200F-AT	200	3φ 220	50	2	Cont.	17.96	1.796	2600	1.09	7.49	0.749	-
				60			14.12	1.412	3200	0.89	6.09	0.609	
				50	2	Cont.	19.37	1.937	2600	1.10	7.49	0.749	
				60			15.30	1.530	3200	0.91	6.09	0.609	
9IDD4(K)-200F-A	9IDD4(K)-200F-AT	200	3φ 380	50	2	Cont.	17.57	1.757	2600	0.55	7.49	0.749	-
				60			13.91	1.391	3200	0.48	6.09	0.609	
				50	2	Cont.	19.15	1.915	2600	0.58	7.49	0.749	
				60			15.27	1.527	3200	0.49	6.09	0.609	
9IDD5(L)-200F-A	9IDD5(L)-200F-AT	200	3φ 415	50	2	Cont.	17.01	1.701	2600	0.55	7.49	0.749	-
				60			13.45	1.345	3200	0.45	6.09	0.609	
				50	2	Cont.	18.87	1.887	2600	0.57	7.49	0.749	
				60			14.87	1.487	3200	0.46	6.09	0.609	

1) Enter the phase & voltage code in the place * within the motor model name.

2) The phase & voltage code G, K, L contain a built-in thermal protector.

* It is not possible to use an inverter for three phase 380~440V motor. When the inverter is used, the insulation of winding coil becomes hot and may cause damage to the motor.

Dimensions

LEAD WIRE TYPE

MOTOR MODEL: 9IDD□-200F-A (GENERAL FAN)

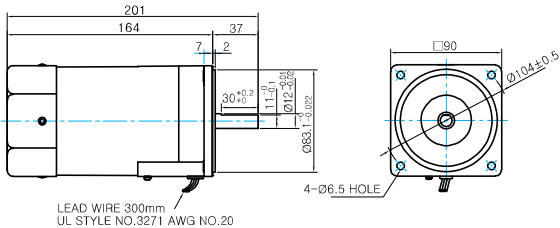

MOTOR OUTPUT SHAFT

MODEL	SPEC
D-CUT TYPE	
9IDD□-200F-A	
KEY TYPE	
9IDK□-200F-A	

KEY SPEC

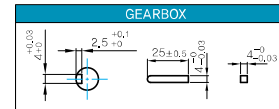

TERMINAL BOX TYPE

MOTOR MODEL: 9IDD□-200F-AT (GENERAL FAN)

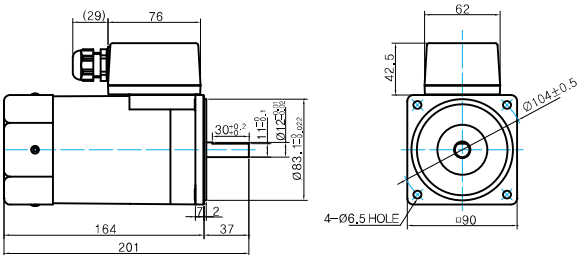

WEIGHT

PART	WEIGHT(Kg)
MOTOR	3.8

Motor Images

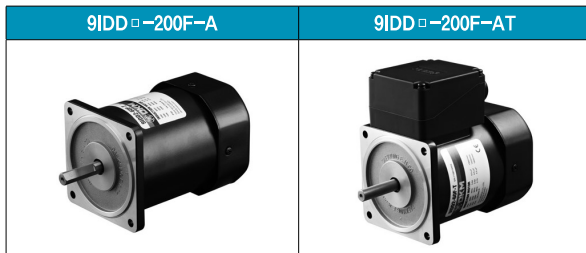

Connection Diagrams

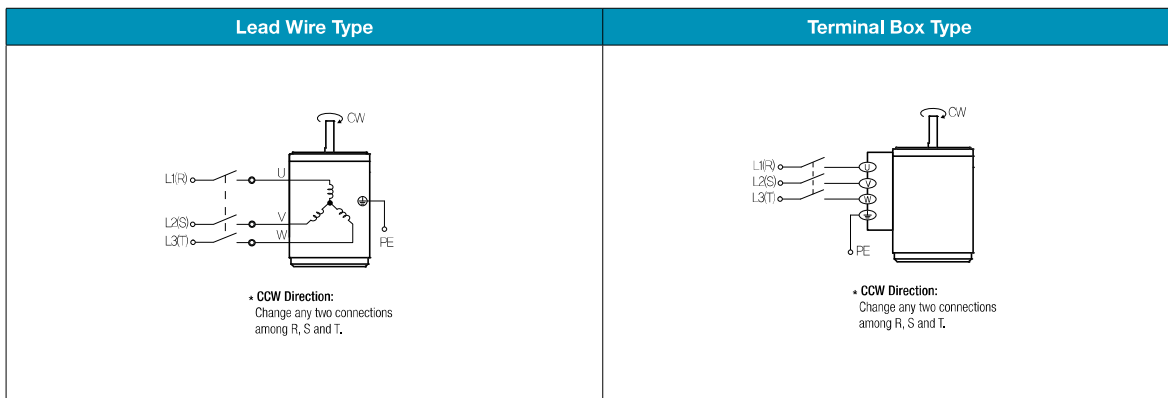

- 1) The direction of motor rotation is as viewed from the shaft end of the motor.
- 2) CW represents the clockwise direction, while CCW represents the counterclockwise direction.